



DATE STAMP

ES Fechador Anual DE Datumsteller
IT Datario Annuale PT Datador Anual FR Corps Dateur

● Cad Insertion Point

FA

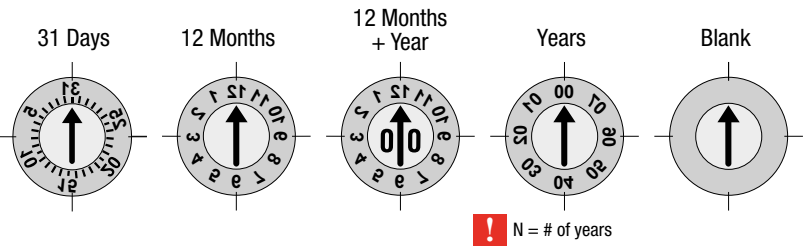
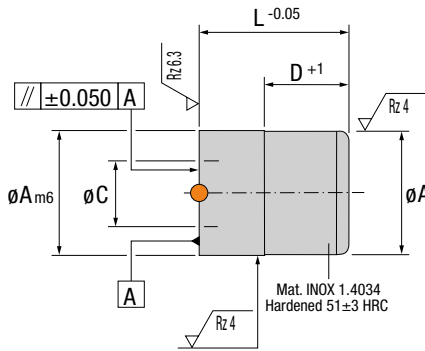

Patented



Max. 150°C

IMPORTANT ! Special engraving available under request.
Grabados especiales bajo demanda.
Andere Gravuren auf Anfrage.
Incisioni speciali su richiesta.
Gravações especiais por encomenda.
Gravure spéciale par commande.

IMPORTANT ! Indicate the year after the reference.
Indicar el año después de la referencia.
Geben Sie das Jahr nach dem Verweis an.
Indicare l'anno dopo il codice.
Indicar o ano depois da referência.
Indiquer l'année après la référence.

	31 Days	12 Months	12 Months+Year	Years	Blank	A	C	D	E	L	N
	-	FA.0422SF	FA.042212-..	FA.042204-..	FA.042200	4	2.2	6	3.5	12	4
	-	FA.0530SF	FA.053012-..	FA.053004-..	FA.053000	5	3	6	3.5	12	4
FA.063231	FA.0632SF	FA.063212-..	FA.063205-..	FA.063200	6	3.2	12	4	20	5	
FA.084731	FA.0847SF	FA.084712-..	FA.084705-..	FA.084700	8	4.7	12	6	20	5	
FA.105731	FA.1057SF	FA.105712-..	FA.105706-..	FA.105700	10	5.7	12	8	20	6	
FA.126731	FA.1267SF	FA.126712-..	FA.126708-..	FA.126700	12	6.7	12	10	20	8	
FA.168731	FA.1687SF	FA.168712-..	FA.168710-..	FA.168700	16	8.7	12	12	20	10	
FA.200731	FA.2007SF	FA.200712-..	FA.200710-..	FA.200700	20	10.7	12	14	20	10	



DATE INSERT

ES Inserto Anual DE Einsätze für Datumsteller
IT Inserto Datario PT Indicador Anual FR Insert Dateur

IA

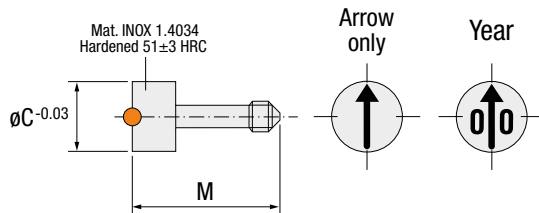

Replacement for FA and FP

Arrow Only	Year	C	M
IA.2275SF	IA.2275..	2.2	8.1
IA.3075SF	IA.3075..	3	8.1
IA.3217SF	IA.3217..	3.2	17
IA.4717SF	IA.4717..	4.7	17
IA.5717SF	IA.5717..	5.7	17
IA.6717SF	IA.6717..	6.7	17
IA.8717SF	IA.8717..	8.7	17
IA.1007SF	IA.1007..	10.7	17

Installation Guidelines
Consejos de Instalación · Richtlinien zur Installation · Consigli di Installazione
Instruções de Instalação · Mode d'Installation

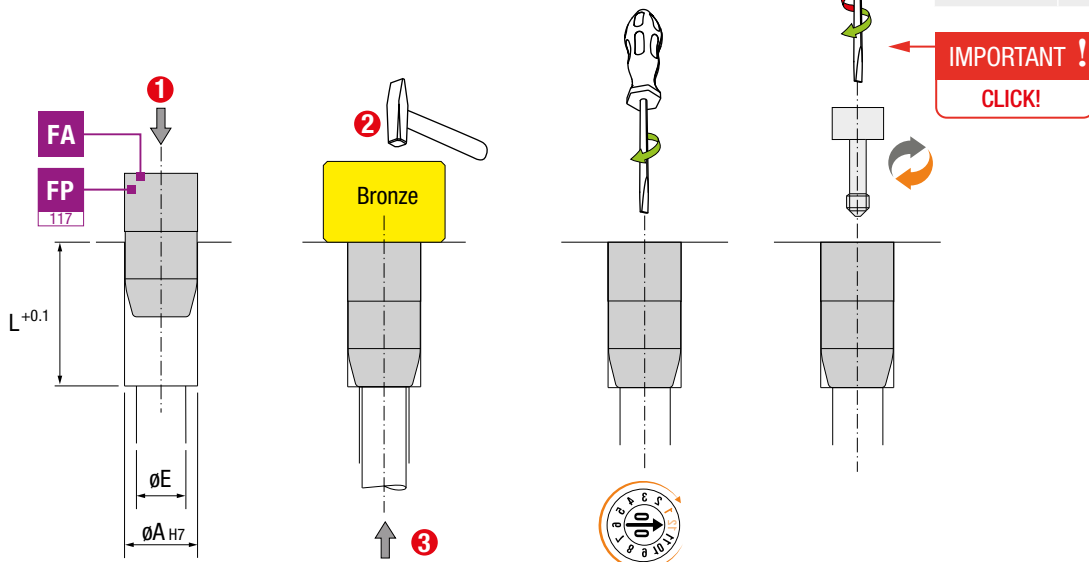

Max. 150°C