

XTREME DOUBLE RACK

ES Doble Cremallera Xtreme DE Extremer Double Rack
 IT Doppia cremagliera Xtreme PT Xtreme Double Rack FR Double Crémallière Xtreme

● Cad Insertion Point

XR

Patented

Max. 120°C

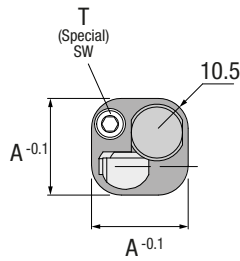
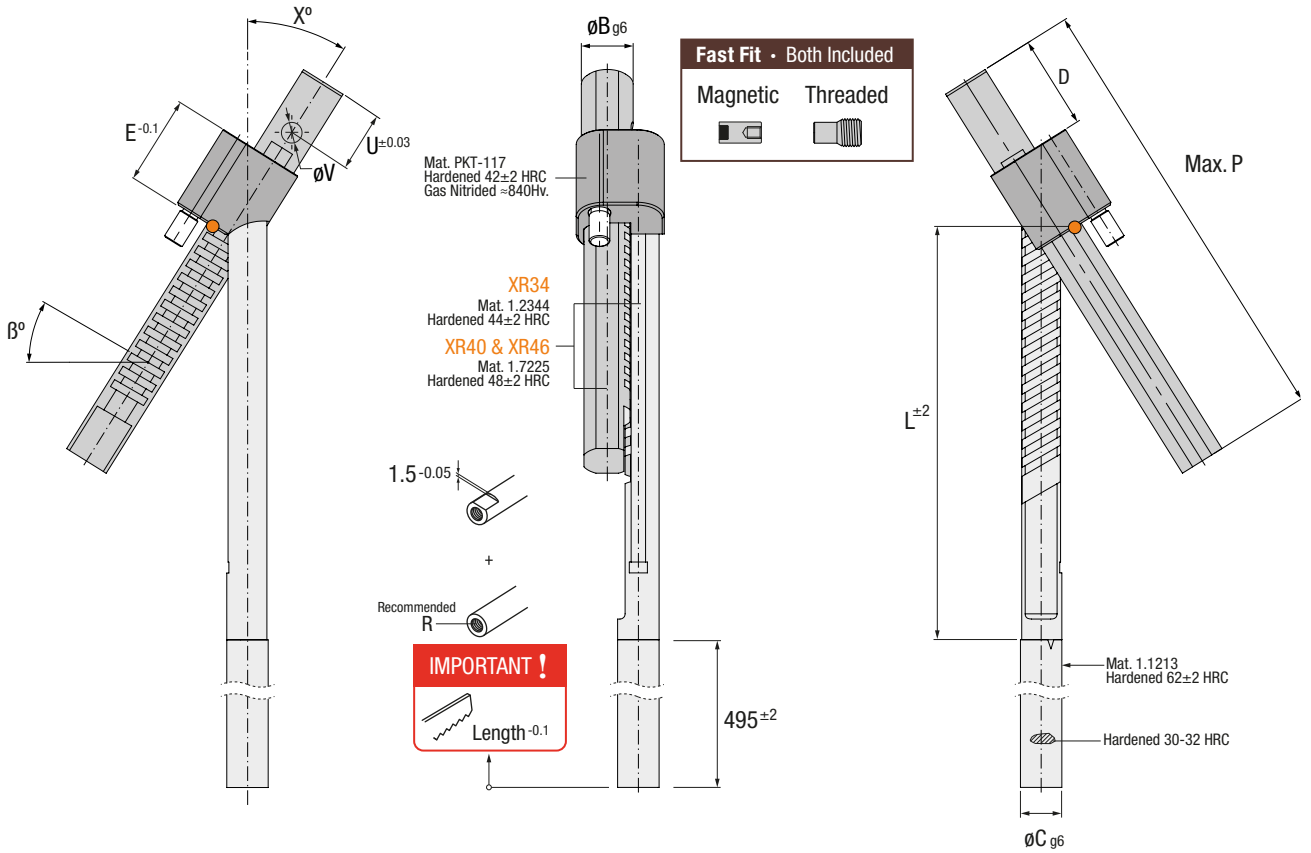

IMPORTANT !
 Mirror Part.
 Pieza Simétrica.
 Symmetrisches Teil.
 Versione specchiata.
 Peça em Espelho.
 Pièce en Miroir.

Stroke 100	X°	A	B	C	D	E	L	P	R	T	U	V	Stroke 100-S	SWa
XR34100L-x	24 28 32 36	34	20	16	36	34	159	225	M8	M8	23	8	XR34100L-x-S	5
XR40100L-x	24 28 32 36	40	22	20	36	40	170	240	M10	M10	20	10	XR40100L-x-S	6
XR46100L-x	24 28 32 36	46	24	24	42	46	174	255	M10	M12	26	10	XR46100L-x-S	8

! HOW TO ORDER

Check page 48-49 for Min / Max β values

$\beta^\circ < 0$ & $\beta^\circ = 0$ $\beta^\circ > 0$

A Stroke X° β
 XR 34 100L - 28 -10 Standard XR 34 100L - 28 +10

XR 34 100L - 28 -S -10 Symmetrical XR 34 100L - 28 -S +10
A Stroke X° β

INSTALLATION GUIDELINES

ES Consejos de Instalación DE Richtlinien zur Installation
 IT Consigli di Installazione PT Instruções de Instalação FR Mode d'Installation

XR

Patented
 Max. 120°C

Core Housing
 Alojamiento Placa Punzón
 Einbaumaße DR Führung
 Sede nel Punzone
 Alojamento Bucha
 Logement dans l'empreinte

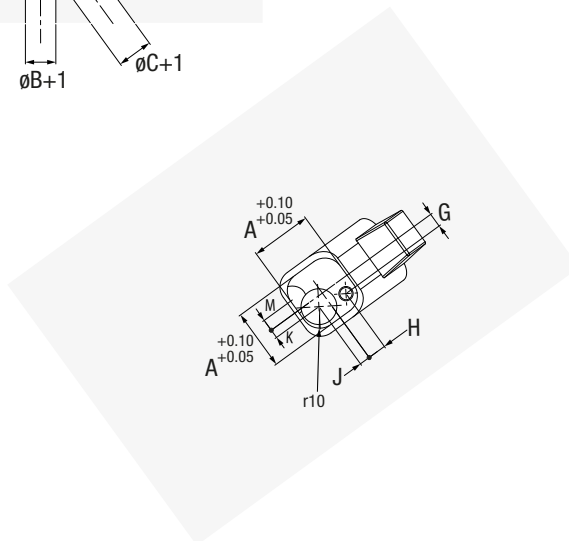
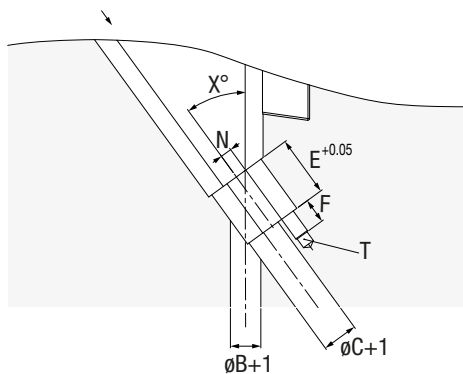

Stroke 100	F	FR1	FR2	G	H	J	K	M	N	S	T	W	Y	Z	SWb
XR34100L..	16	5.3	M10x1	8	10.5	6	5	7	6	4	M8	8	16	M4	5
XR40100L..	20	8.5	M12x1	11	11	7	7	8	7	4	M10	10	20	M6	6
XR46100L..	25	8.5	M12x1	13	13	9	9	8	8	5	M12	10	24	M6	8

Installation

Instalación · Montage · Montaggio · Instalação · Montage

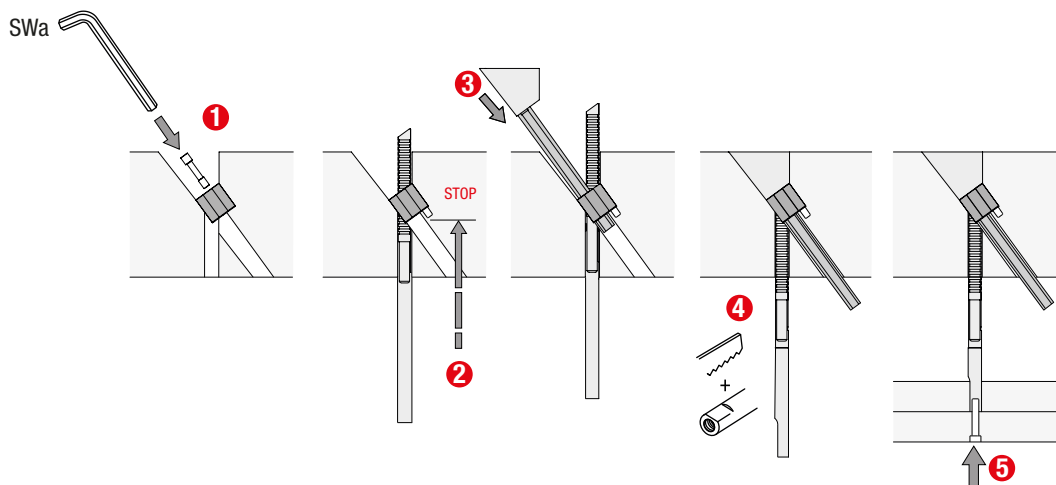
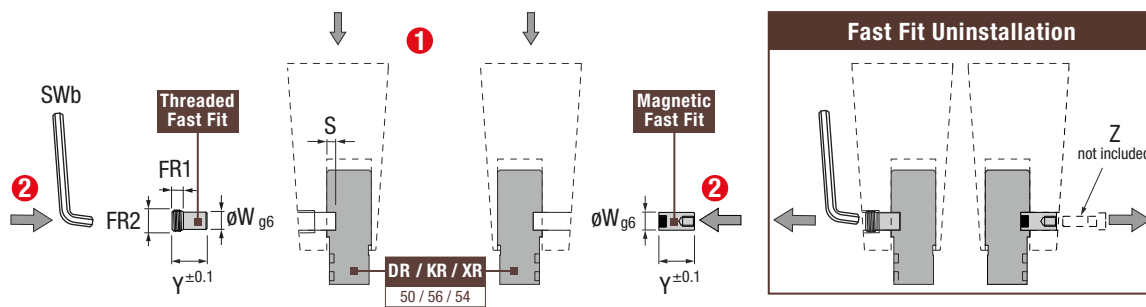

DOUBLE RACK SYSTEM

by CUMSA

COMPARE

Comparativa · Vergleich · Confronto · Comparativo · Comparatif

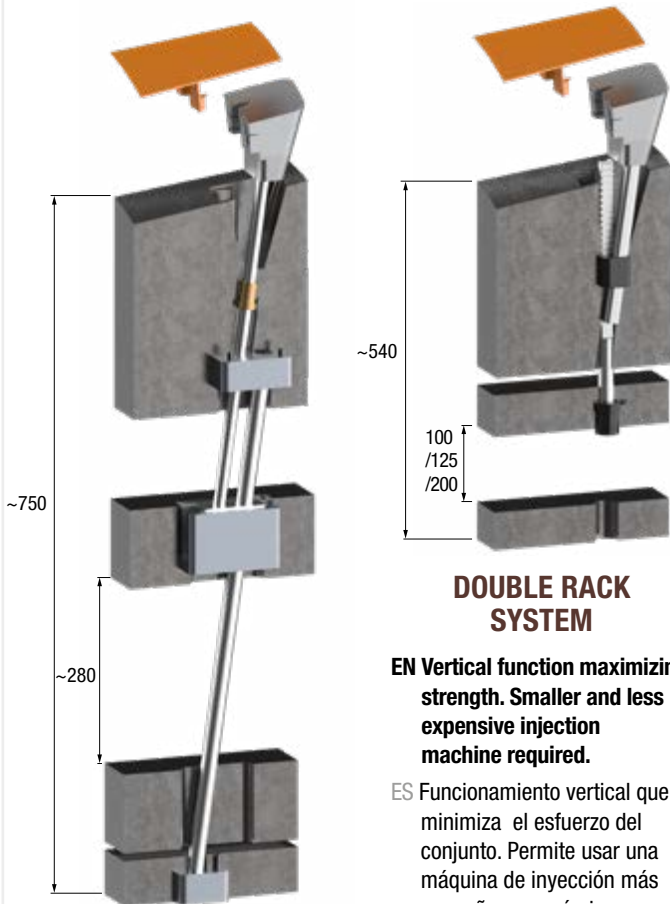

DOUBLE RACK SYSTEM

EN Vertical function maximizing strength. Smaller and less expensive injection machine required.

ES Funcionamiento vertical que minimiza el esfuerzo del conjunto. Permite usar una máquina de inyección más pequeña y económica.

DE Vertikale Funktion mit maximaler Kraft. Ein kleineres Werkzeug kann eventuell eine kleinere und günstigere Spritzgießmaschine benötigen.

IT Funzionamento verticale che minimizza lo sforzo. Permette di usare una macchina d'iniezione più piccola ed economica.

PT Funcionamento na vertical minimizando o esforço. Permite o uso de máquinas de injeção de menores dimensões e mais económicas.

FR Fonctionnement vertical réduisant les efforts. Permet de réduire la dimension de la presse d'injection et ainsi de réaliser des économies.

CONVENTIONAL SYSTEM

EN Eliminates the need for high-precision angled housings in the core plates.

ES Elimina los complicados taladros inclinados de alta precisión.

DE Es wird keine hochpräzise Schrägbohrung in der Formplatte benötigt.

IT Elimina le complicate lavorazioni inclinate ad alta precisione.

PT Elimina a necessidade de furos inclinados com precisão.

FR Termine les logements inclinés de haute précision.

Neutral angles ($\beta^\circ=0^\circ$)

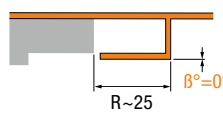

$S \geq R$

DR.xx100L-16
KR.xx200L-16
DR.xx125L-12
KR.xx125L-12
XR.xx100L-24

Positive Angles ($\beta^\circ>0^\circ$)

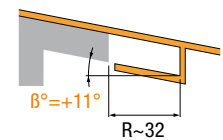

$S \geq R$

DR.xx100L-20
DR.xx125L-16
KR.xx125L-16
XR.xx100L-24

Negative Angles ($\beta^\circ<0^\circ$)

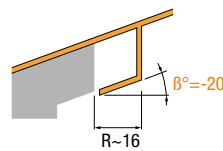

$S \geq R$

DR.xx100L-12
KR.xx200 L-12
DR.xx125L-8
KR.xx125L-8
XR.xx100L-24

IMPORTANT !

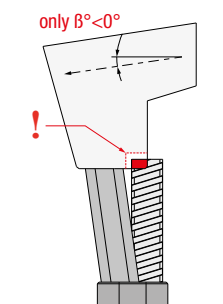

Stroke 100 (DR) Stroke 200 (KR) (Multiply S value x2)

β°	DR.xx100L-8		DR.xx100L-12	
	S (- β°)	S (+ β°)	S (- β°)	S (+ β°)
0	14.0	14.0	21.2	21.2
1	14.0	14.0	21.1	21.3
2	13.9	14.1	21.1	21.4
3	13.9	14.1	21.0	21.5
4	13.9	14.1	20.9	21.5
5	13.8	14.2	20.8	21.6
6	13.8	14.2	20.7	21.7
7	13.8	14.3	20.7	21.8
8	13.7	14.3	20.6	21.9
9	13.7	14.3	20.5	22.0
10	13.7	14.4	20.4	22.0
11	13.6	14.4	20.4	22.1
12	13.6	14.4	20.3	22.2
13	13.6	14.5	20.2	22.3
14	13.5	14.5	20.1	22.4
15	13.5	14.6	20.1	22.5
16	13.5	14.6	20.0	22.6
17	13.4	14.6	19.9	22.7
18	13.4	14.7	19.8	22.8
19	13.4	14.7	19.8	22.9
20	13.3	14.8	19.7	23.0
21	13.3	14.8	19.6	23.1
22	13.2	14.9	19.5	23.2
23	13.2	14.9	19.4	23.3
24	13.2	14.9	19.4	23.4
25	13.1	15.0	19.3	23.5
26	13.1	15.0	19.2	23.7
27	13.1	15.1	19.1	23.8
28	13.0	15.1	19.0	23.9
29	13.0	15.2	19.0	24.0
30	12.9	15.2	18.9	24.2
31	12.9	15.3	18.8	
32	12.9	15.4	18.7	
33	12.8	15.4	18.6	
34	12.8	15.5	18.5	
35	12.7	15.5	18.5	
36	12.7		18.4	
37	12.7		18.3	
38	12.6		18.2	
39	12.6		18.1	
40	12.5		18.0	
45	12.3		17.5	
50	12.0		16.9	
55	11.7		16.3	
60	11.3		15.5	

