

# EXTERNAL DOUBLE EJECTION

ES Doble Expulsión Externa DE Externer Zweistufenauswerfer  
IT Doppia Espulsione Esterna PT Dupla Extração Externa FR Double Éjection Externe

● Cad Insertion Point

# EY

## EJECTION



Max.  
150°C

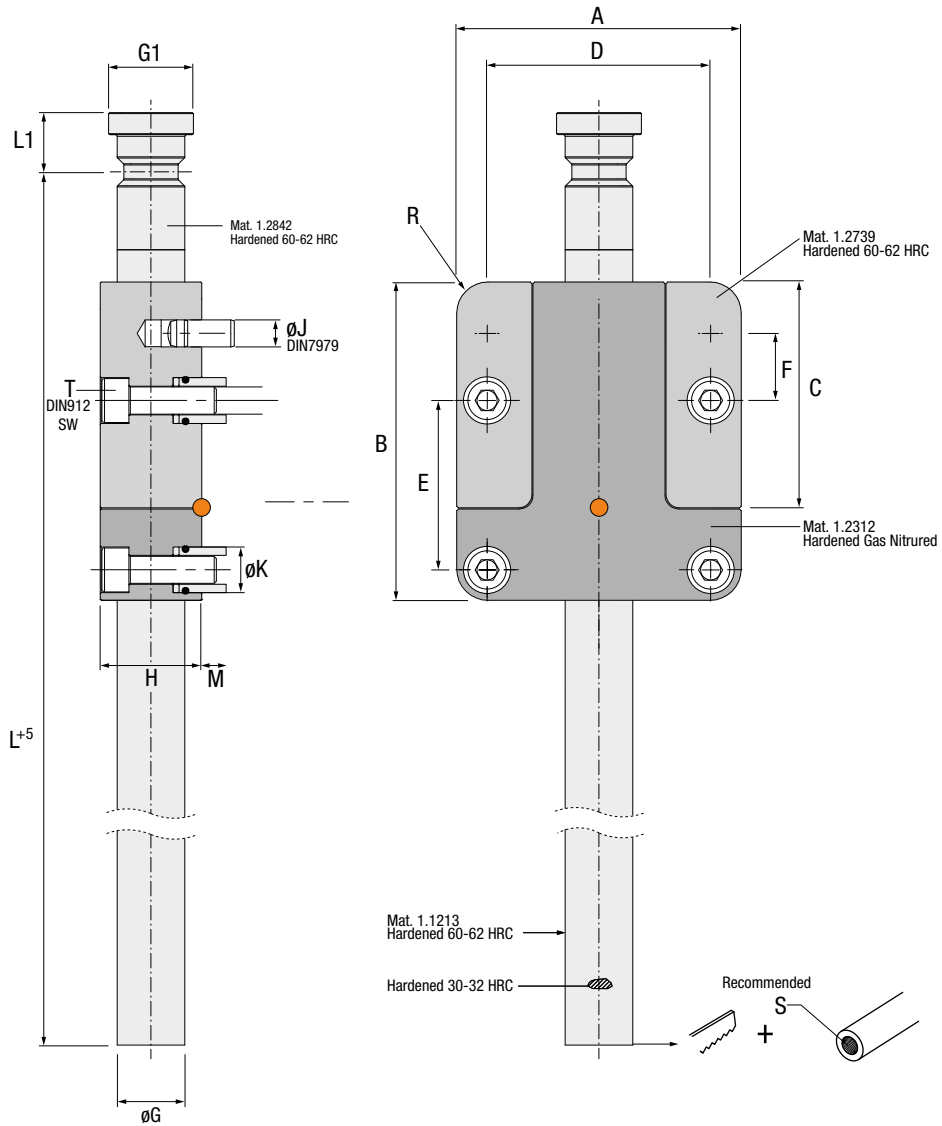

## EXTERNAL APPLICATION

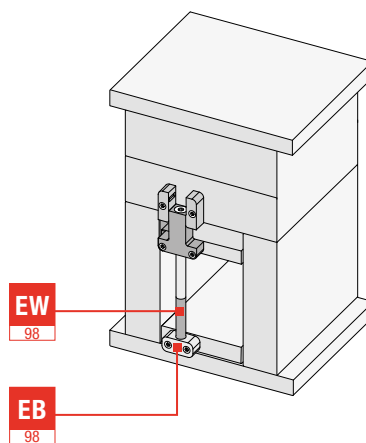

Ref.	A	B	C	D	E	F	G	G1	H	J	K	L	L1	M	R	S	T	X	Y
EY.140600	62	70	50	48	38	18	14	18	22	Ø6x20	10.5	348	13	5.5	7.2	M8	M6x30	15	13
EY.200800	84	94	67	66	50	26	20	25	30	Ø8x20	13.5	348	17.5	7.5	9.2	M12	M8x40	20	17.5
EY.321200	126	144	102	102	82	38	32	39	46	Ø10x30	18.5	530	27	11.5	12.5	M16	M12x65	25	27
EY.501600	174	200	140	140	113	53	50	55	64	Ø12x40	25	530	40	15.5	17	M24	M16x90	35	40



# INSTALLATION GUIDELINES

ES Consejos de Instalación DE Richtlinien zur Installation  
IT Consigli di Installazione PT Instruções de Instalação FR Mode d'Installation



# EY

## EJECTION



Max.  
150°C

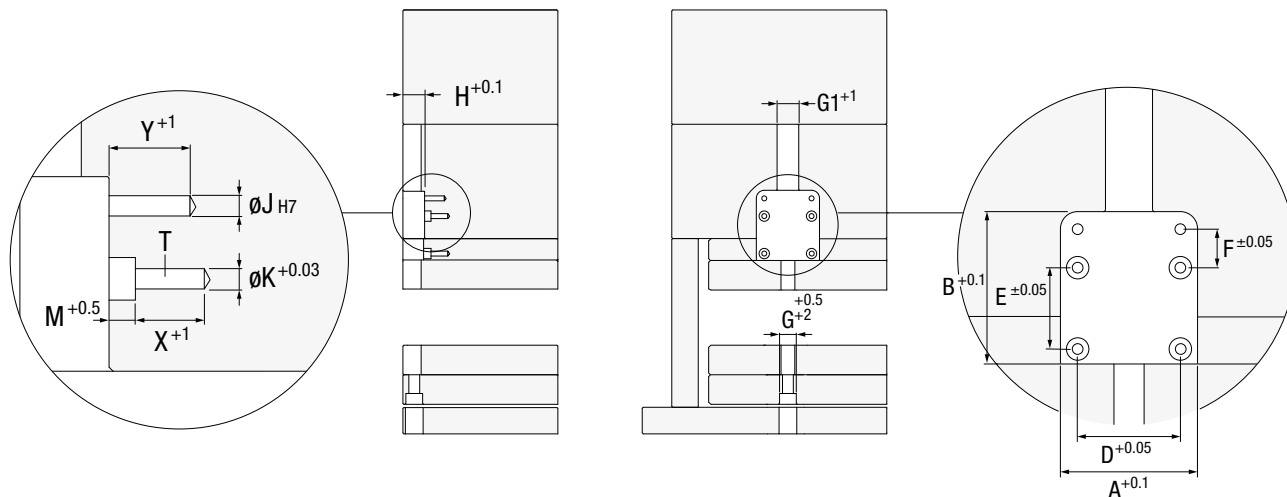

## THREE PLATE MOLD APPLICATION

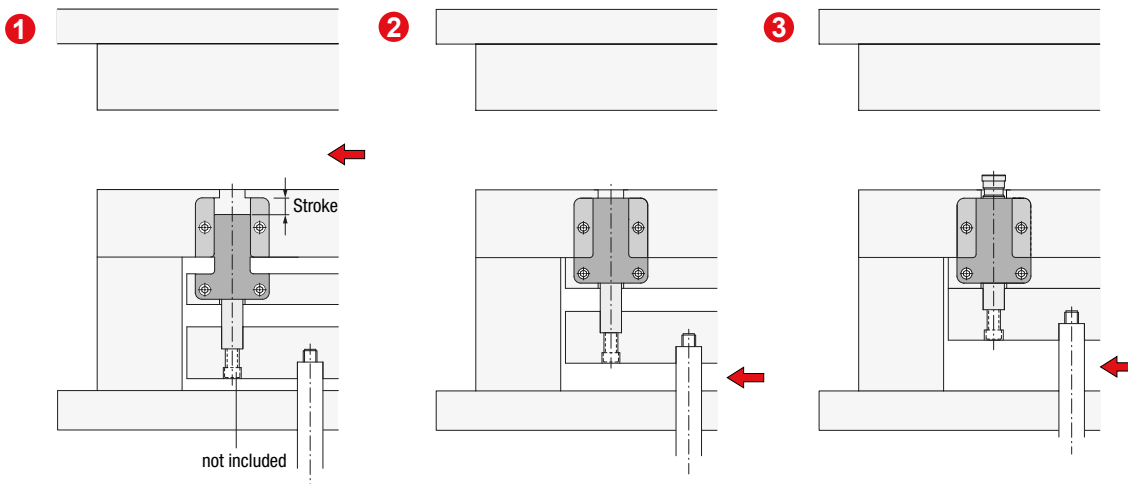

	Min. Stroke	Max. Stroke	RF (N)	SW
	6	30	4.000	5
	8	40	9.000	6
	14	60	20.000	10
	20	80	40.000	14

