

EY_EXTERNAL DOUBLE EJECTION

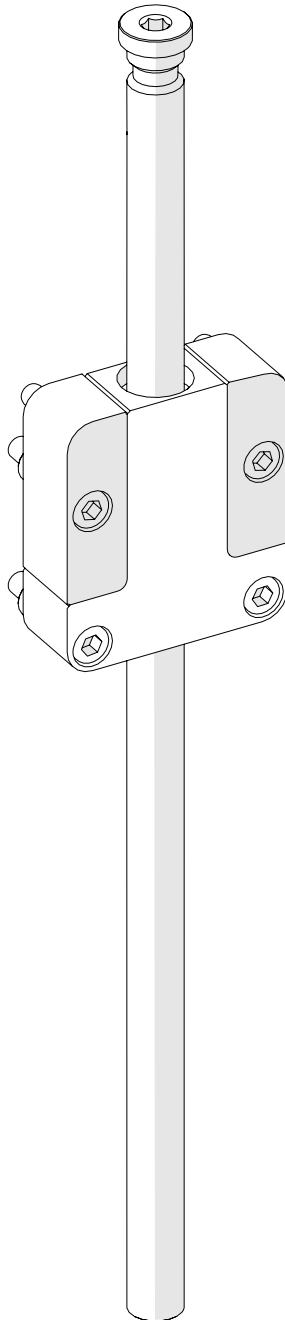

WHAT'S INCLUDED IN THE PACKAGE

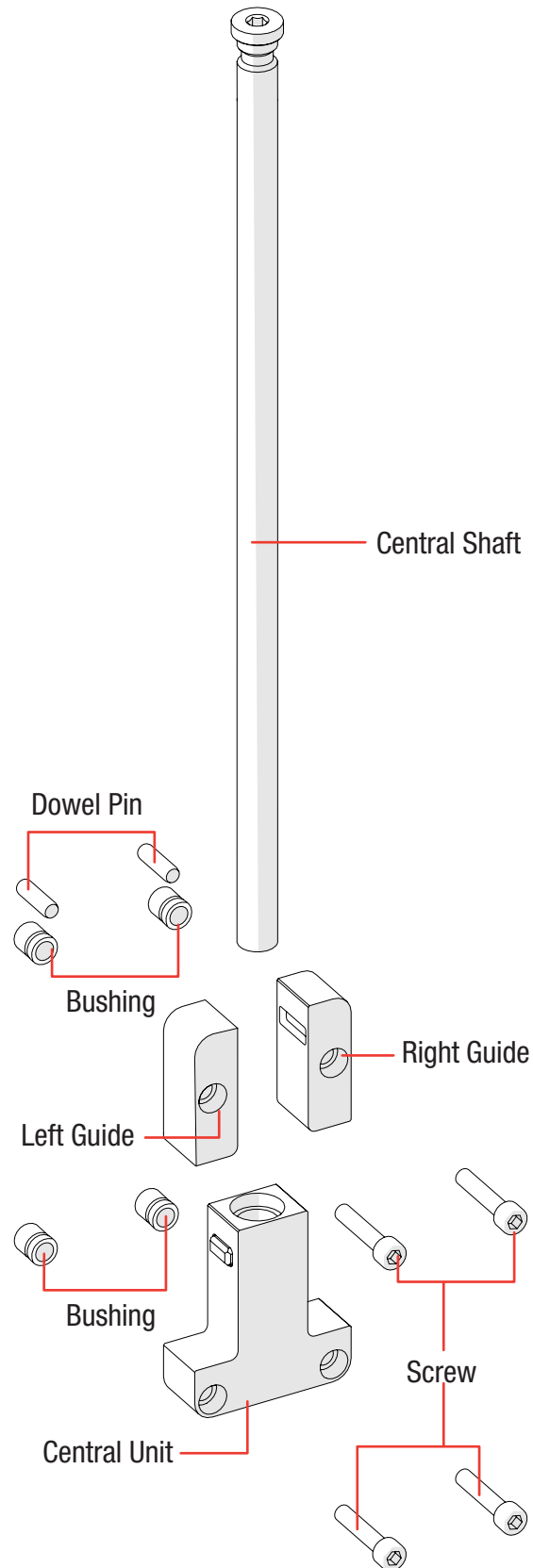

EY_PRODUCT APPLICATION OPTIONS

TRAILING DOUBLE EJECTION

1

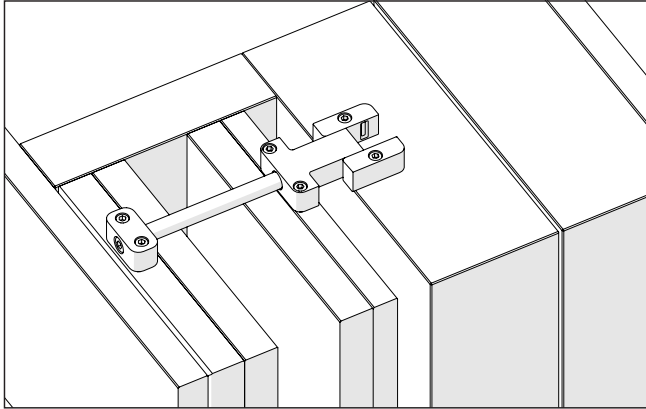

2

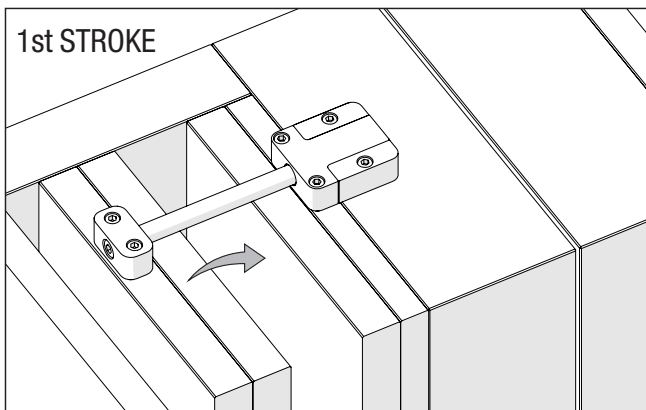

3

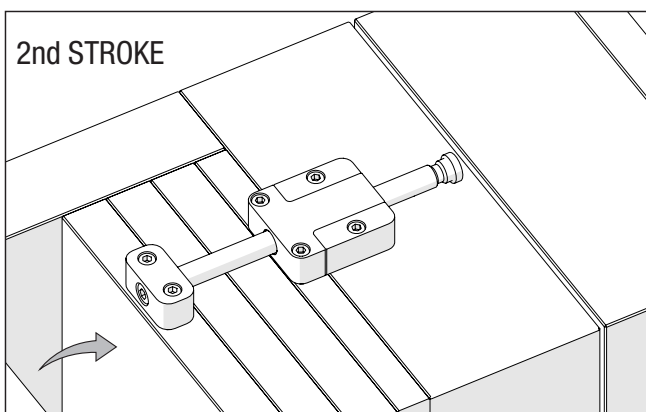

EY_CORE INSTALLATION

1

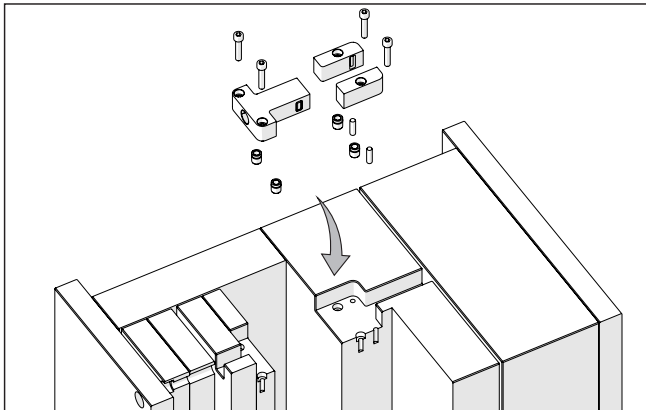

2

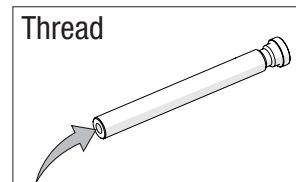
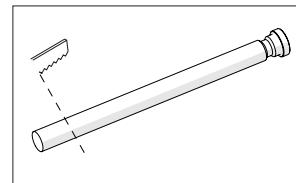
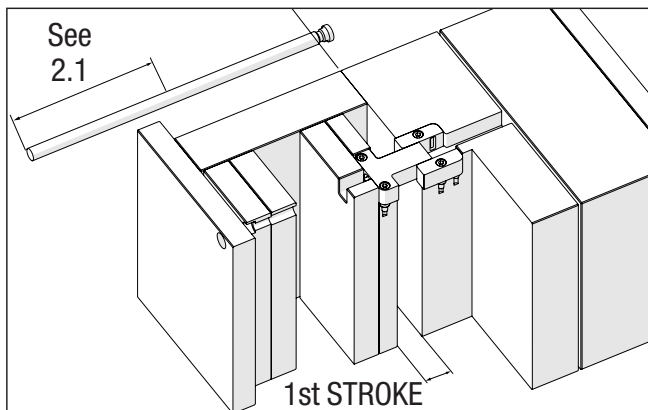

3

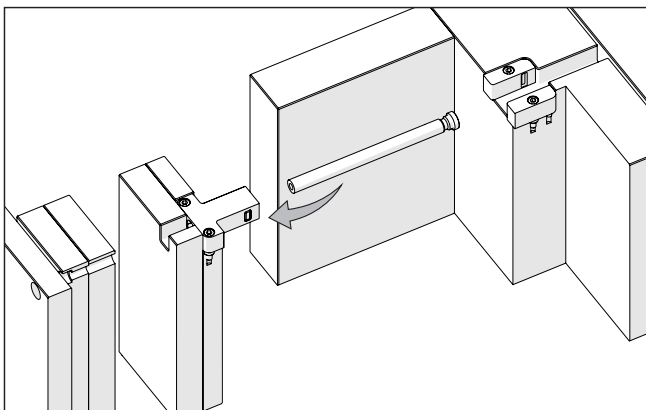

EY_CORE INSTALLATION

4

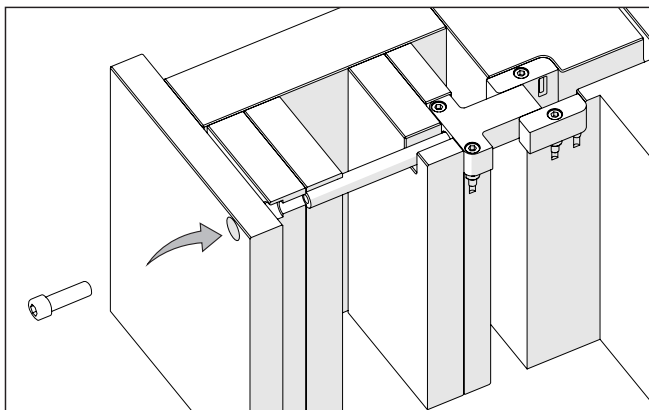

5

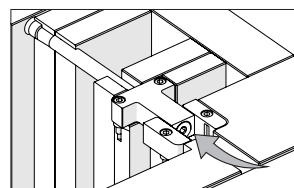
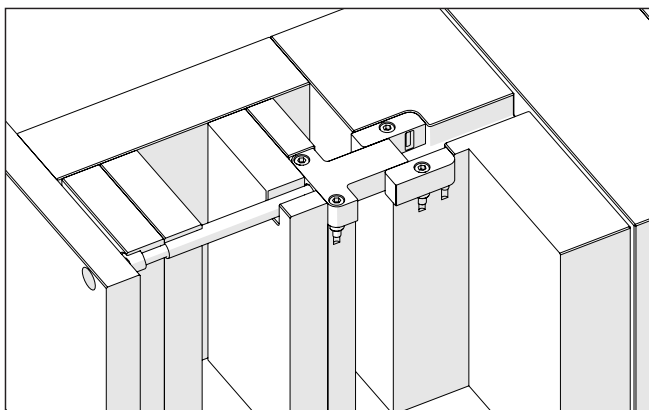

6

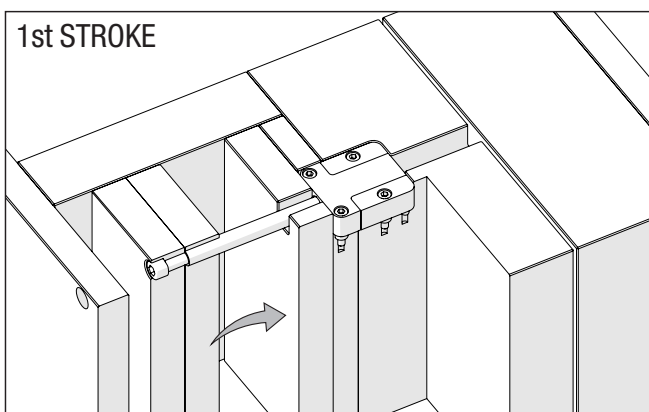

EY_CORE INSTALLATION

7

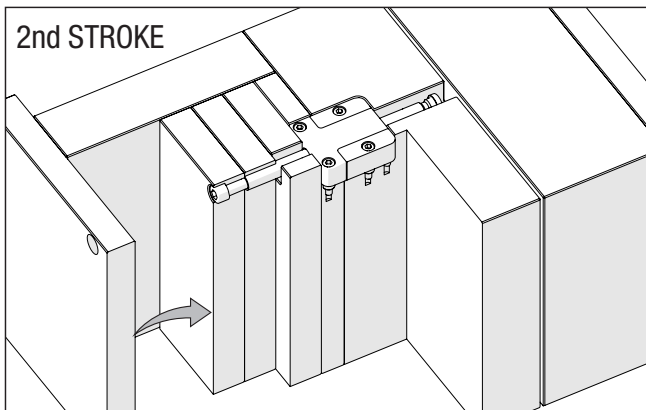

EY_EXTERNAL INSTALLATION

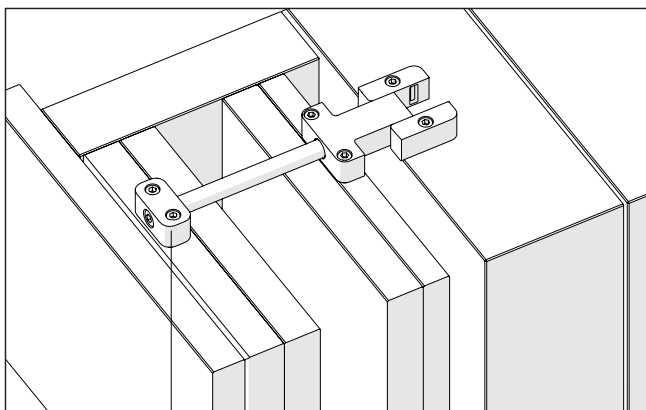

Using **EB** component.

CUMSA

INNOVATIVE SOLUTIONS
FOR YOUR MOLDS

EY_UNLOCKING THE SHAFT

