

EX_EXTERNAL SUPERIOR PLATE SEPARATOR

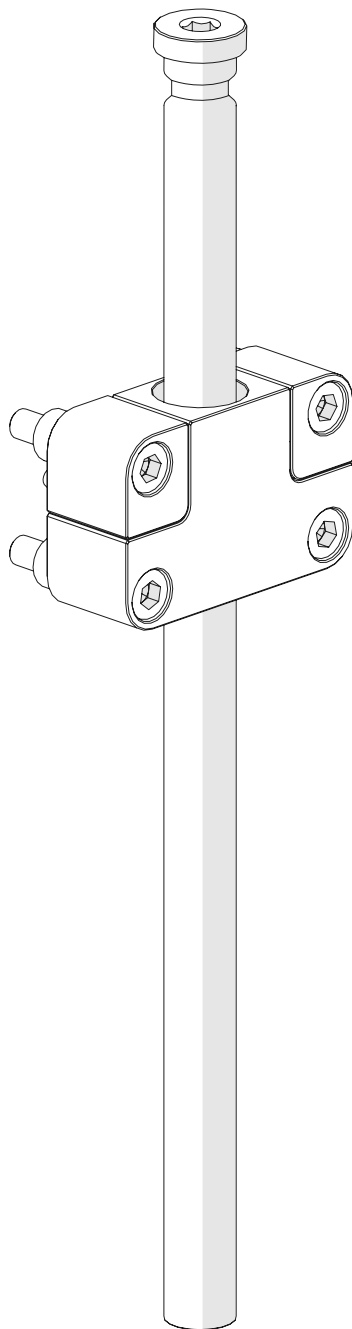

CUMSA
INNOVATIVE SOLUTIONS
FOR YOUR MOLDS

WHAT'S INCLUDED IN THE PACKAGE

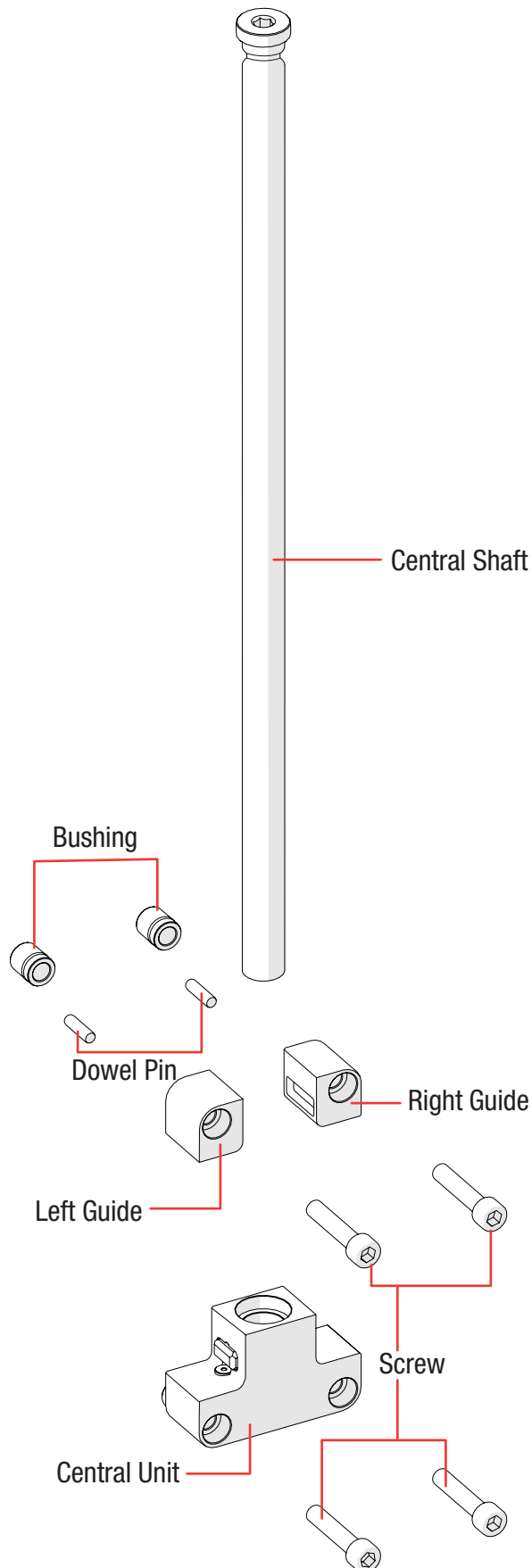

EX_ONE PRODUCT TWO APPLICATION OPTIONS LEADING DOUBLE EJECTION INSTALLATION

1

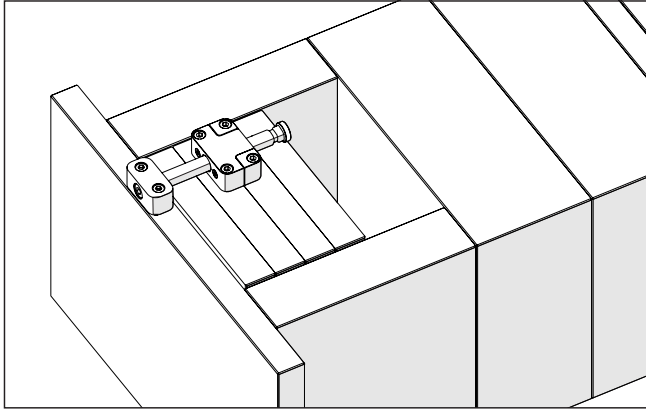

2

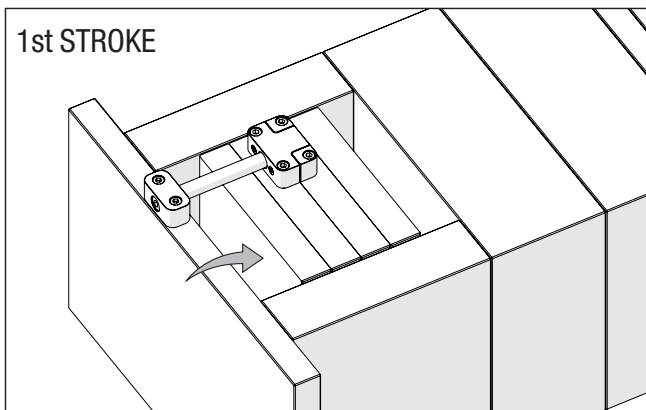

3

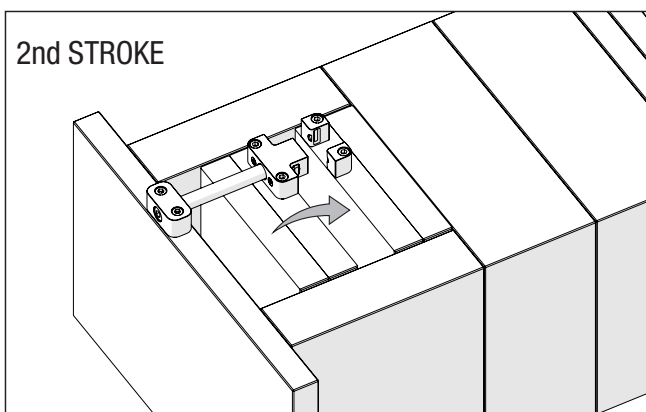

EX_ONE PRODUCT TWO APPLICATION OPTIONS THREE PLATE MOLD INSTALLATION

1

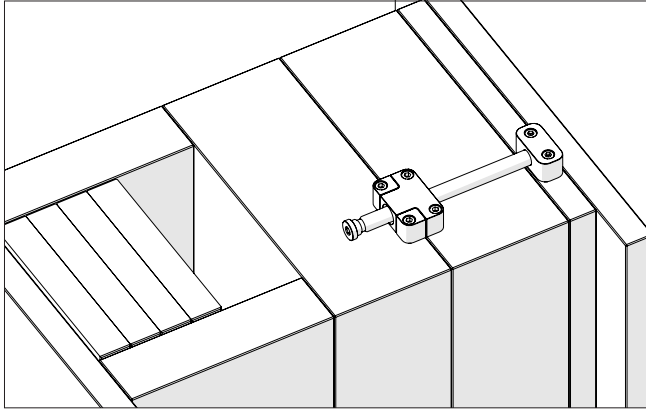

2

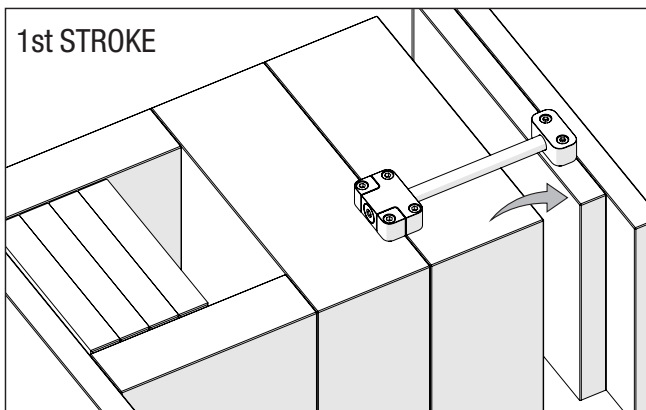

3

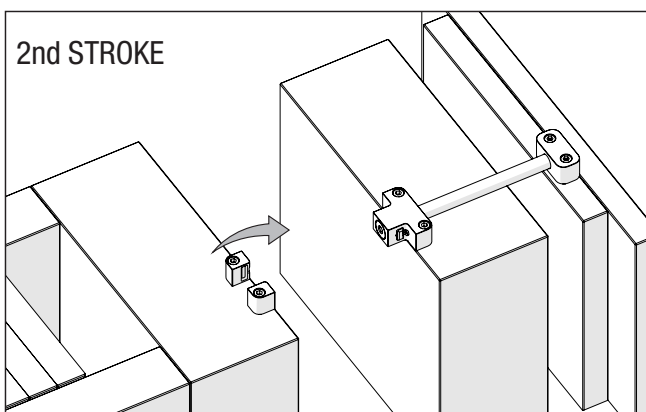

EX_CORE INSTALLATION

1

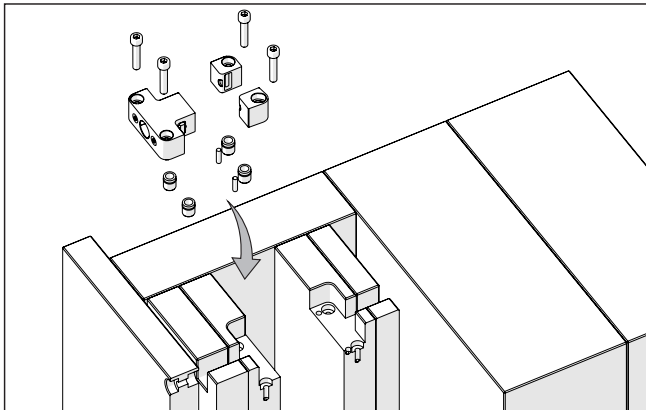

2

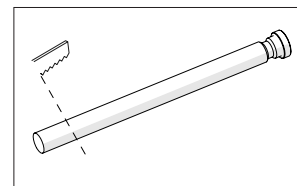
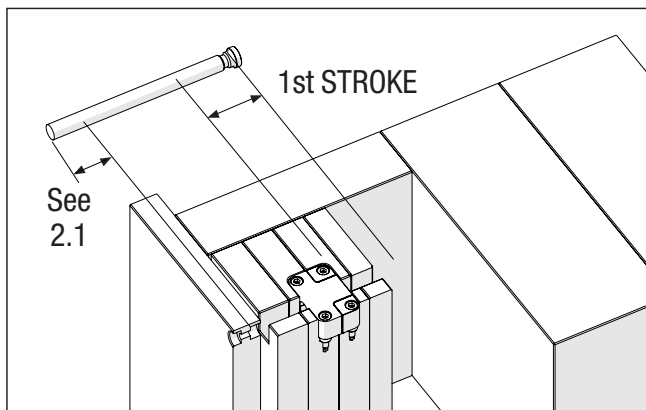

2.1

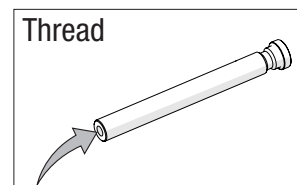

2.2

3

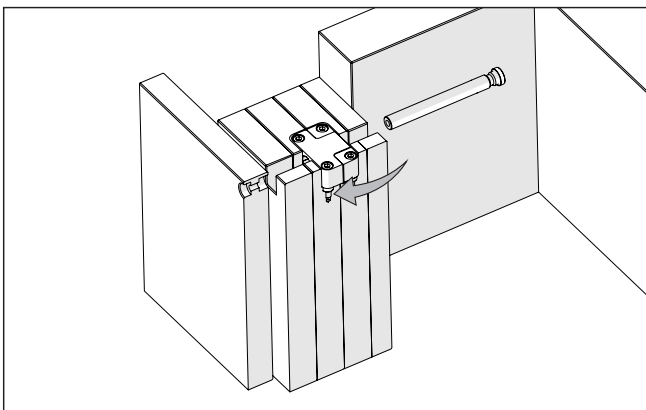

EX_CORE INSTALLATION

4

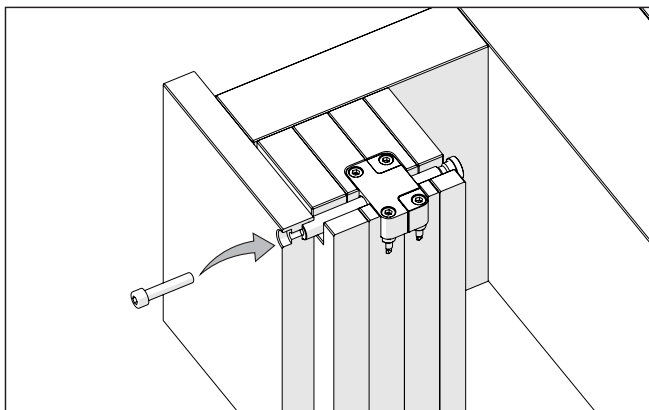

5

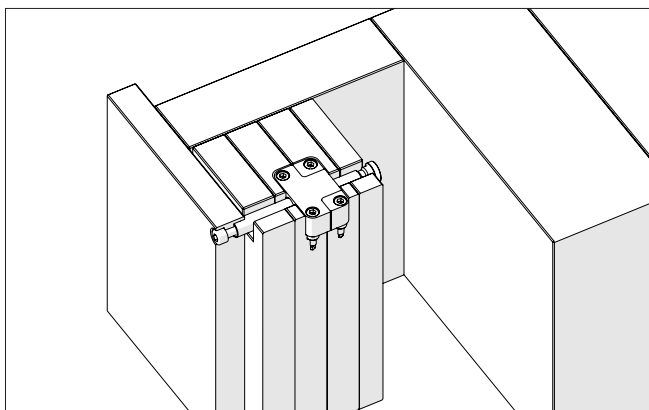

6

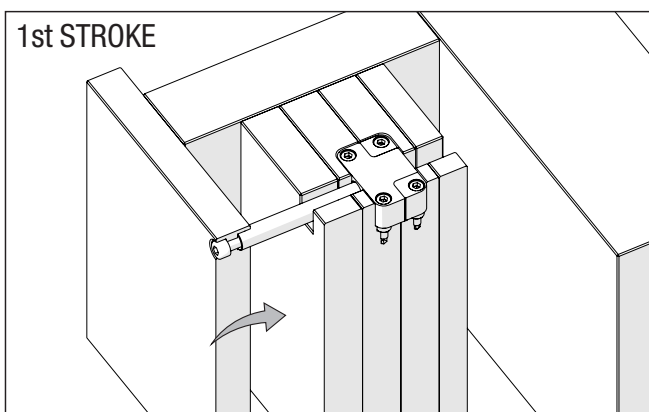

EX_CORE INSTALLATION

7

2nd STROKE

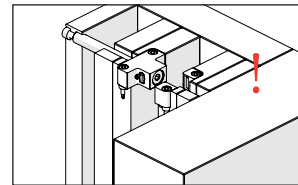
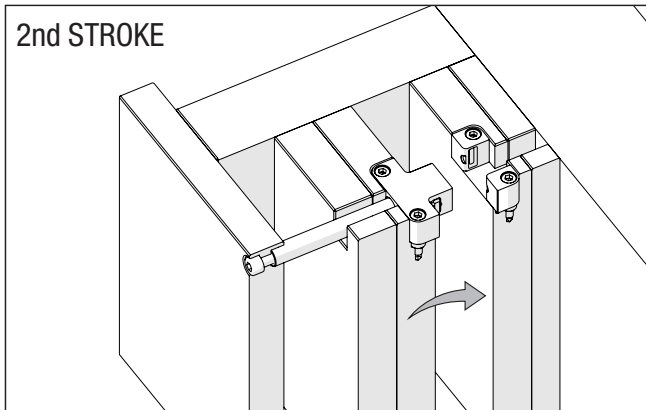

7.1

Check "Unlocking the shaft" section

EX_EXTERNAL INSTALLATION

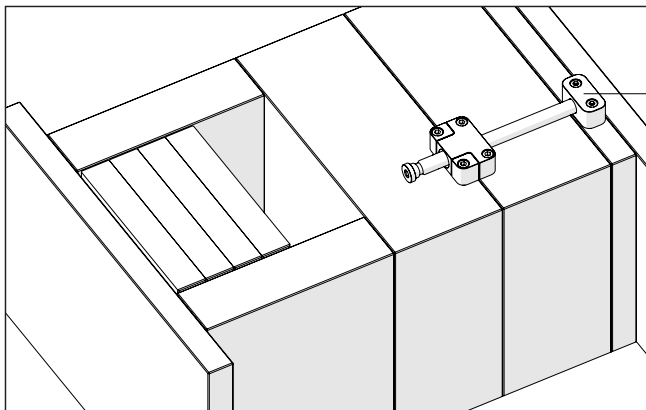

Using **EB** component.

EX_UNLOCKING THE SHAFT

