

CUMSA

INNOVATIVE SOLUTIONS
FOR YOUR MOLDS

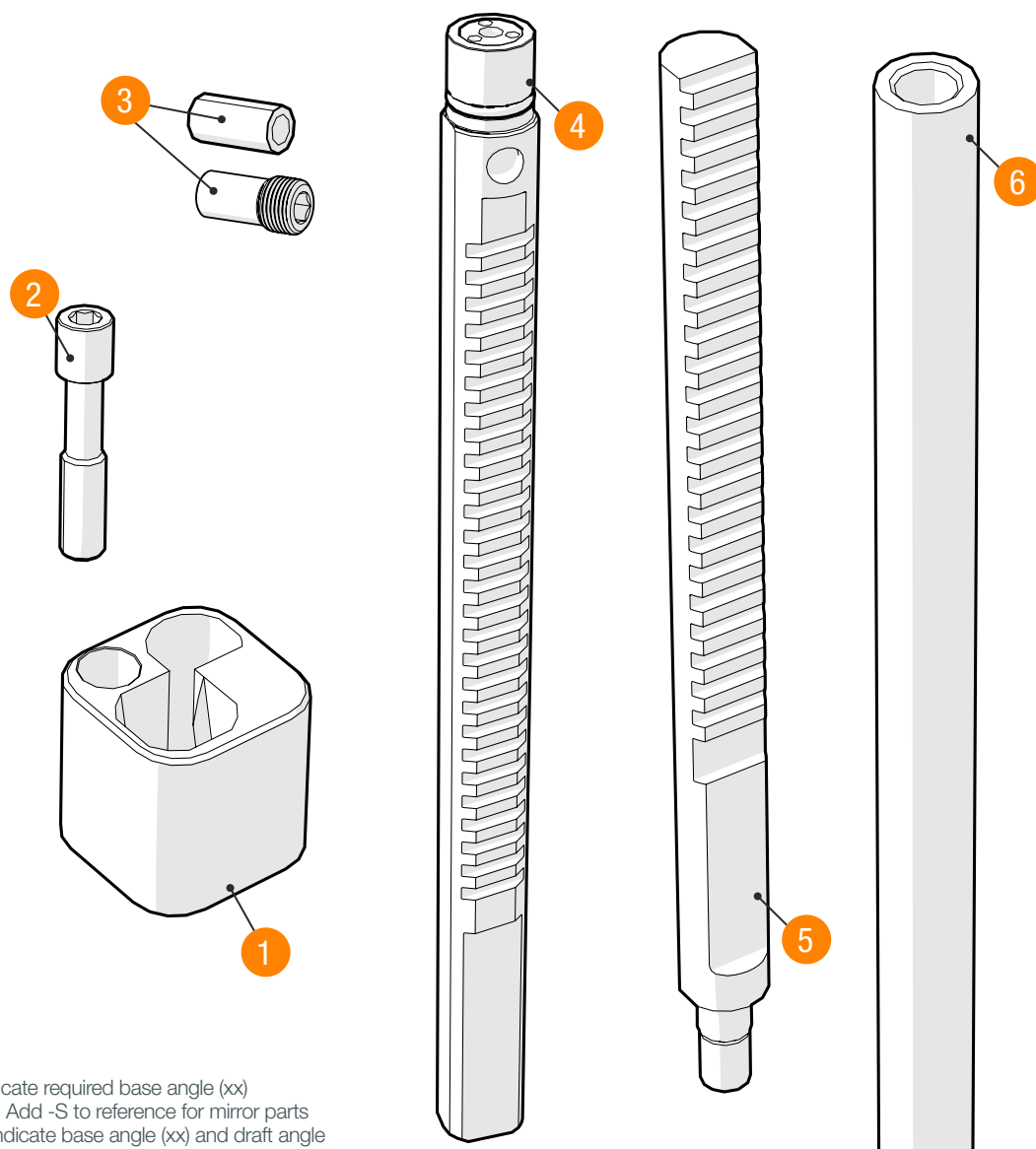

ID 1 - Indicate required base angle (xx)
ID 1/4/5 - Add -S to reference for mirror parts
ID 4/5 - Indicate base angle (xx) and draft angle

SPARE PART LIST: DOUBLE RACK COMPONENTS - KR

ID	Description	KR.22125L-xx xx:08°,12°,16° or 20°	KR.28125L-xx xx:08°,12°,16° or 20°	KR.34125L-xx xx:08°,12°,16° or 20°	KR.40125-xx xx:08°,12°,or 16°	KR.46125L-xx xx:08°,12°,or 16°	KR.58200-xx xx:08°,12°,or 16°	KR.76200L-xx xx:08°,12°,or 16°
1	KR Base Unit	9DR-22xx14-BASE	9DR-28xx16-BASE	9DR-34xx20-BASE	9DR-40xx22-BASE	9DR-46xx24-BASE	9KR-58xx30-BASE	9KR-76xx40-BASE
2	Base Unit Screw	9DR2206-TOR	9DR2808-TOR	9DR3408-TOR	9DR4010-TOR	9DR4612-TOR	9KR5814-TOR	9KR7618-TOR
3	Fast Fit	9DR2208FF	9DR2808FF	9DR3408FF	9DR4010FF	9DR4610FF	9KR5812FF	9KR7612FF
4	Angled Shaft	9KR22125L-EI	9KR28125L-EI	9KR34125L-EI	9KR40125L-EI	9KR46125L-EI	9KR58200L-EI	9KR76200L-EI
5	Vertical Shaft	9KR22125L-EV	9KR28125L-EV	9KR34125L-EV	9KR40125-EV	9KR46125-EV	9KR58200L-EV	9KR76200L-EV
6	Extension	9DR22-AL	9DR28-AL	9DR34-AL	9DR40-AL	9DR46-AL	9KR58-AL	9KR76-AL